

## Home For Sale: 1815 REEDIE DR - \$399,000



**Remarks** Wonderful location !

House is being sold"AS IS" - needs TLC.

As-is/where is. See floor plan.

House is vacant but please be mindful of current social distancing restrictions now in place.

- No more than 3 people may be in the house at one time.
- Large groups should not enter together.
- Wait outside for your turn to go inside.

Lower level has large room that can easily be turned into one or two bedrooms.

Nice lot.

Close to METRO.

Rooms	Total	Main	Upper 1	Upper 2	Lower 1	Lower 2
Bedrooms	3	3				
Full Baths	2	2				
Half Baths	1	1				

### Basic Information

**Address** 1815 REEDIE DR  
**City/Town** SILVER SPRING  
**State** MD  
**Zip Code** 20902  
**County** MONTGOMERY  
**Type** Detached

**MLS#** MDMC703860  
**Ownership** Fee Simple  
**Style** Split Foyer  
**Adv Subdivision** WESTCHESTER  
**Year Built** 1958  
**Beds** 3

**Baths** 2/1  
**Lot Size** 10708.00  
**Acres** 0.25  
**Levels** 2  
**Total Fin Sq Ft** 2212

### Exterior/Construction Features/Utilities

**Exterior** Brick  
**Roof** Asphalt  
**Water Type** Public

**Sewer** Public Sewer  
**Hot Water** Natural Gas  
**Heating** Central

**Cooling** Central A/C

### Tax/Legal Information

**Tax ID #** 01413054  
**Tax Year** 2019  
**Tax Assessment Value** \$398, 100

**Total Taxes** \$4, 780  
**County Tax** \$3, 826  
**Short Sale** No

**Foreclosure** No  
**REO/Bank Owned** No

### Interior Features/Amenities

**TV/Cable** Natural Gas Available, Electric Available, Phone, Sewer Available, Water Available

**Basement** Daylight, Partial

Information Courtesy of Long & Foster Real Estate, Inc.. Copyright 2020 Bright MLS. Information is believed to be accurate, but should not be relied upon without verification. Accuracy of square footage, lot size and other information is not guaranteed.



**Barbara CIMENT**  
Your Home Team

**Emily Lurie of the Barbara Ciment Team**



**LONG & FOSTER**  
REAL ESTATE

(H) 301-983-8333 (Cell) 301-537-5712 (O) 301-424-0900





# Floor Plans 1815 Reddie Drive, Silver Spring, MD 20902

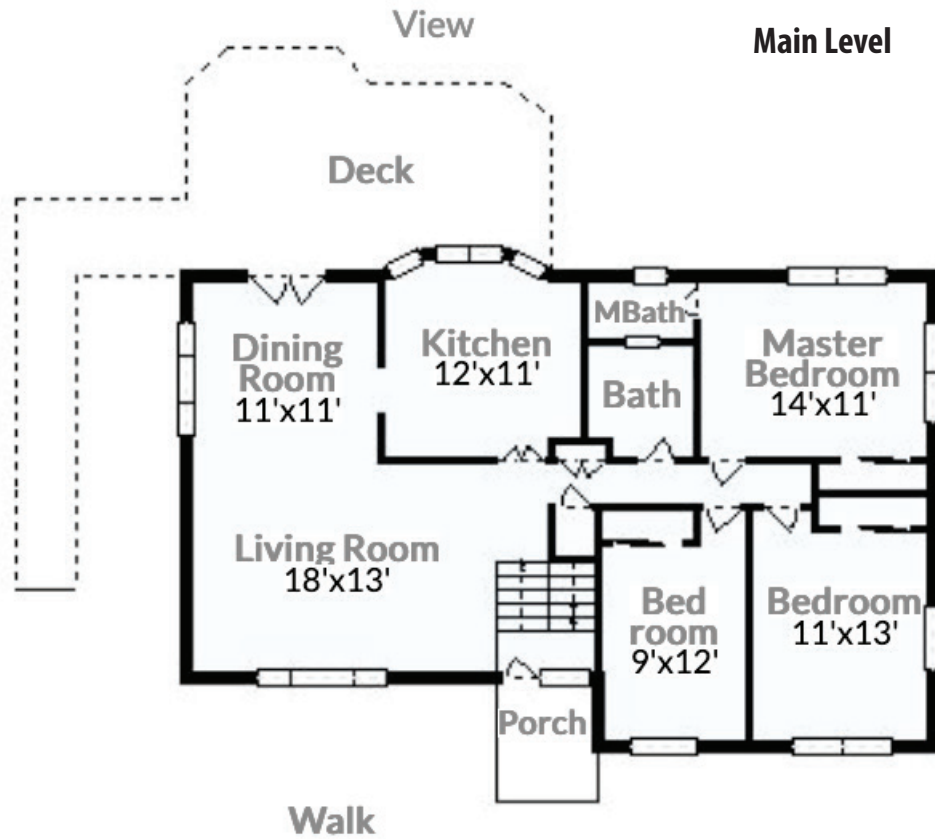

## Lower Level

