

## Recent Home Sale: 4600 N PARK AVE #PW - \$1,050,000



**Remarks** Chevy Chase office for sale, includes 6 garage parking spaces. Condo Fee \$921.96 includes all utilities except for electric. 64' x 15' private outdoor patio.

Rooms	Total
Bedrooms	
Full Baths	
Half Baths	

### Basic Information

**Address** 4600 N PARK AVE #PW  
**City/Town** CHEVY CHASE  
**State** MD  
**Zip Code** 20815

**County** MONTGOMERY  
**MLS#** MDMC655956  
**Ownership** Condominium  
**DOM-Prop** 268

**Year Built** 1991  
**Contract Date** 2019-12-03  
**Close Date** 2020-02-25  
**Close Price** \$1,050,000

### Exterior/Construction Features/Utilities

**Exterior** Brick  
**Water Type** Public

**Sewer** Public Sewer  
**Hot Water** Electric

**Heating** Central  
**Cooling** Central A/C

### Tax/Legal Information

**Tax ID #** NO TAX RECORD  
**Tax Year** 2018  
**Tax Assessment Value** \$1,086,300

**Total Taxes** \$12,556  
**Legal Subdiv** PARK AVE CENTER A CODM  
**Short Sale** No

**Foreclosure** No  
**REO/Bank Owned** No

### HOA/Condo/Coop Info

**Project Name** PARK AVE CENTER

Information Courtesy of AMR Commercial, LLC. Copyright 2021 Bright MLS. Information is believed to be accurate, but should not be relied upon without verification. Accuracy of square footage, lot size and other information is not guaranteed. This website courtesy of Barbara Ciment, Realtor, Long & Foster Real Estate, Inc.



**CIMENT & SHIELDS TEAM**

**Barbara Ciment, Associate Broker**

**LONG & FOSTER REAL ESTATE**

(C) 301-346-9126 (O) 301-424-0900  
barbara@ciment.com www.ciment.com



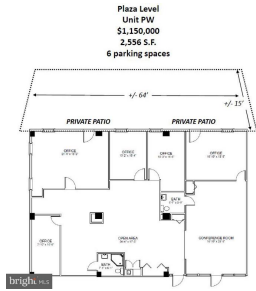

**CIMENT & SHIELDS TEAM**

**Barbara Ciment, Associate Broker**

**LONG & FOSTER**  
REALTOR® REAL ESTATE

(C) 301-346-9126 (O) 301-424-0900  
barbara@ciment.com www.ciment.com

